

# How to Trim the Line on a Pre-bled Brake Set without Using a Bleed Kit

If a new pre-bled Shimano brake kit comes with a line that is too long for the bike there is a simple procedure for shortening the line without getting out the bleed kit.



You will need: 3 mm Allen wrench; 8mm open end wrench; plastic tire lever; #1 Phillips head screwdriver; cutters; metal hammer.



1. Remove the brake pads.



2. Squeeze the lever a few times to extract the pistons. Do not let the pistons come completely out of the cali-



per.



3. Unscrew the connecting bolt and remove the line from the lever.



4. Cut the line to the desired length. Make sure you have a nice clean and square cut.



5. Using the supplied hose clamp, install the new olive and connecting insert. Tap in the insert with a hammer until it is flush with the end of the hose.

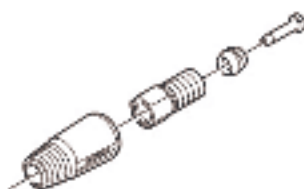

6. Reattach the brake line to the lever. Tighten the connecting bolt until the resistance begins to increase and then turn it one quarter turn more.

7. Making sure that the lever is higher than the caliper, bleed the brakes by pushing the pistons back into the caliper. If any air entered the system when the line was cut it will be forced into the reservoir.



8. Reinstall the brake pads and insert the red pad spacer. Squeeze the brake lever a few times to bring the pistons out into the riding position. The brakes are now ready to be installed on the bike.

